

USER MANUAL IN ORIGINAL

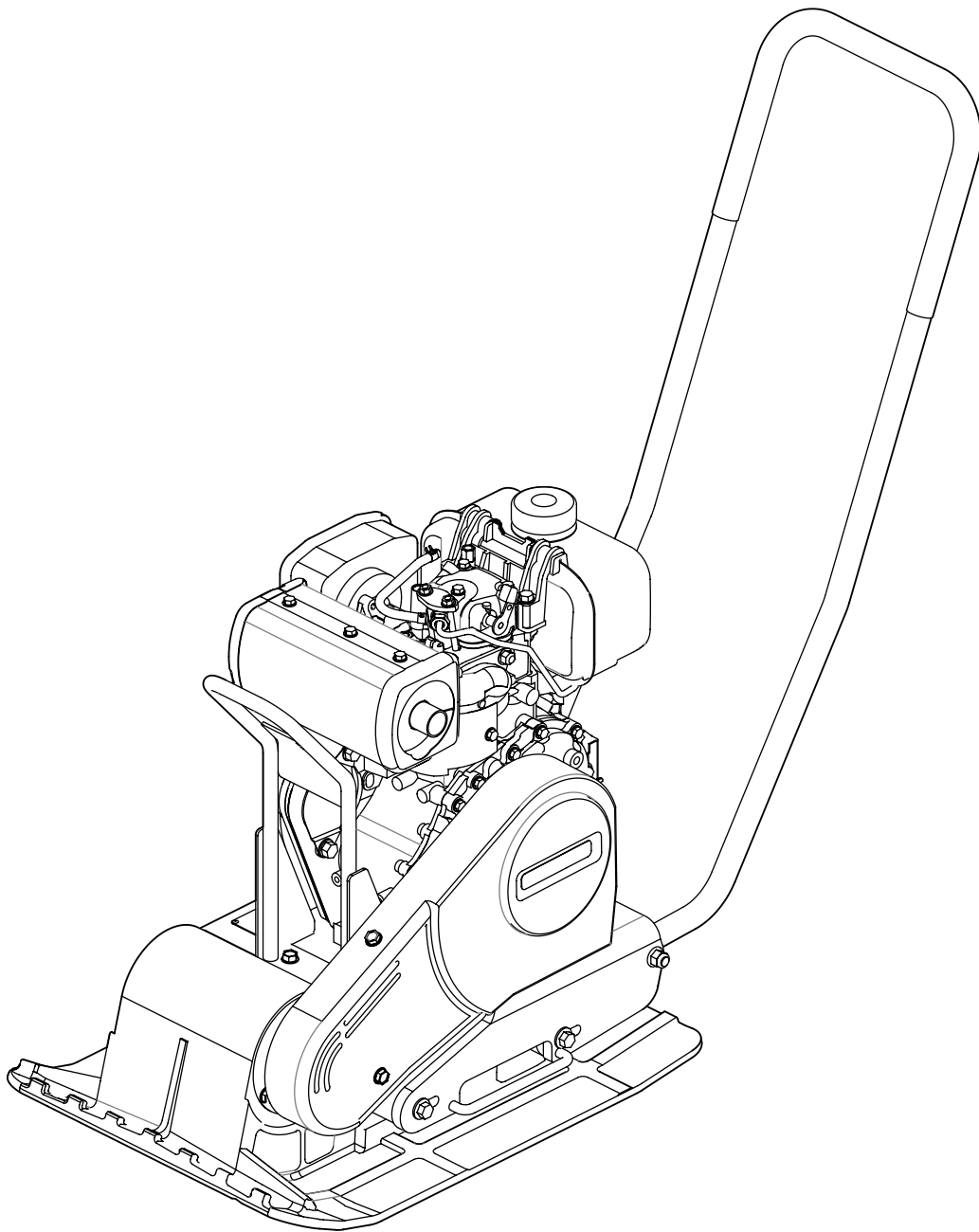

USE

SWEPAC F 100

is used to pack gravel and sand in connection with minor construction work such as the basis for concrete blocks or paving stones for gardens. The machine's compact design ensures good accessibility in tight spaces.

CONTENTS

USE	3
SAFETY INSTRUCTIONS.....	4
STANDARDS	4
SIGNS	5
TECHNICAL DATA.....	6
FUNCTION	6
TECHNICAL DESCRIPTION	7
DAILY CHECKS.....	8
BEFORE STARTING.....	9
STARTING	9
AFTER STARTING.....	9
STOPPING	9
DIMENSIONS.....	10
TRANSPORTATIONS.....	11
EC-DECLARATION OF CONFORMITY.....	13
Note! This chapter applies only to European countries that are members of the European Union	

SAFETY INSTRUCTIONS

- Before using the machine, the operator must be informed of the manufacturer's safety instructions and instructions for use.
- The machine may only be used outdoors.
- The machine may not be used if protection and safety devices are not present or not working.
- The operator may not leave the machine unattended when the engine is on. When the vibrator is connected, the operator must be able to control the movement of the machine using the control handle and the start/stop controls. The machine may be operated only by a trained operator.
- During maintenance work or other interventions in the machine, the engine must always be off.
- Switch the engine off before adding fuel. Avoid fuel spillage and immediately wipe off any spilled fuel. Add fuel only in well ventilated areas.
- Avoid touching hot engine parts, for example the silencer.
- Before lifting the machine, check that the lifting device and its mounting are not damaged and that the rubber dampers on the base plate are undamaged and tightened.
- During transportation and storage, the fuel tank should be empty and the fuel cock switched off.
- The operator must use ear protectors when working with the machine.
- The operator must ensure that no unauthorised persons are in the immediate vicinity of the machine.
- Always wear personal protective equipment as heavy, non-slip shoes, ear protectors and approved eye protection.
- The machine may not be used in environments with potential fire or explosion danger.
- Never use the machine if you are tired or have consumed alcohol or are under medication that could affect your vision, your discretion or your coordination ability.
- Never use a machine in any way changed from the original design

STANDARDS

Noise

Measurement in accordance with the standard EN 500-4 Rev. 1:1998, Annex C:

Measurement uncertainty ± 0.5 dB (A) in 95% of the measurements.

In accordance with the conditions in Directive 2000/14/EC, Annex VI, the following values are reported:

	F 100
Sound pressure level at the operator's ears, L _{pA}	89 dB (A)
Permitted sound power level, L _{WA}	105 dB (A)
Guaranteed sound power level, L _{WA}	105 dB (A)

As the sound pressure level at the operator's ears exceeds 80 dB (A), ear protectors must be used during operation!

Hand/arm vibrations

The vibration acceleration was measured in accordance with the ISO 5349 standard during operation on a grveled surface. The measurement values were translated into the maximum daily exposure time for regular usage. For additional information about vibrations, please confer the regulation AFS 2005:15 from the Swedish Work Environment Authority, effective July 1st 2005. Measurement uncertainty ± 0.3 m/s² in 95% of the measurements.

	F 100
Hand/arm-vibrations, m/s ²	4,5
The maximum daily exposure time	2,5 h

Exhaust emissions

F 100 meets the requirements for California ExH, EYP och EPA PH2

SIGNS

Warning signs

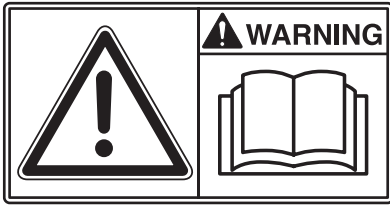

Before use, carefully read the manual and its safety instructions so that you can handle the machine safely. Ensure that the manual is always accessible.

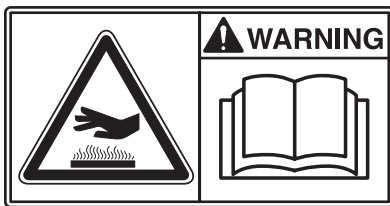

Engine, silencer: to avoid burns or discomfort, do not touch hot engine parts when the engine is on or when the machine has recently been used.



Belt drive: Keep hands, tools and other objects away from the belt drive when the machine is on to avoid injury and damage. See the safety instructions in the manual.



As the sound pressure level at the operator's ears exceeds 80 dB (A), ear protectors must be used when working with the machine to prevent hearing damage.

Machine Signs

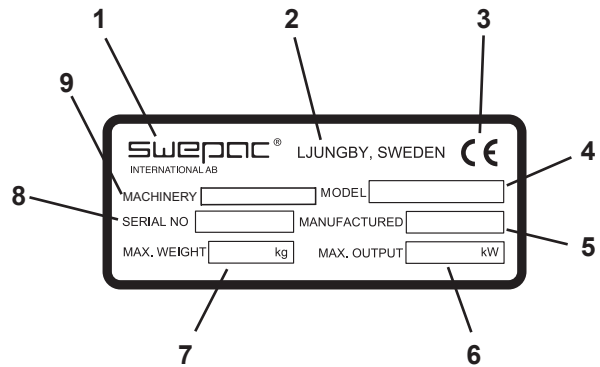

1. Manufacturer
2. Place, country of manufacture.
3. CE mark.
4. Model name.
5. Year of manufacture.
6. Max. engine power.
7. Max. weight.
8. Serial number.
9. Machine type

TECHNICAL DATA**F 100**

Net weight.....	97 kg
Base plate, w x l	380 x 580 mm
Speed.....	appr 25 m/min
Centrifugal force	15 kN
Vibration frequency	88 Hz
Drive engine.....	Yanmar L48
Engine power	3,5 kW
Engine RPM.....	3600RPM
Fuel tank volume.....	2,4liter
Fuel type.....	Diesel
Oil quantity, crankcase.....	0,8liter

FUNCTION

The machine consists of a base plate with a vibration element and an upper part cushioned from the base plate. The power is transmitted from the petrol engine to the vibration element via a V-belt. The engine is fitted with an integrated centrifugal clutch. On account of the direction of rotation and the position of the vibration element at the front end of the base plate, the vibrator moves forward under its own power. The moving parts are well protected by a cover made of impact resistant ABS.

FUEL AND OIL RECOMMENDATIONS

FuelDiesel
 Engine oil.....SAE10W-30
 Engine oil change: first oil change after 20 hours then every 100 hours of operation.

Note! The bearings of the vibrations element of the F 100 are grease smeared.

TECHNICAL DESCRIPTION

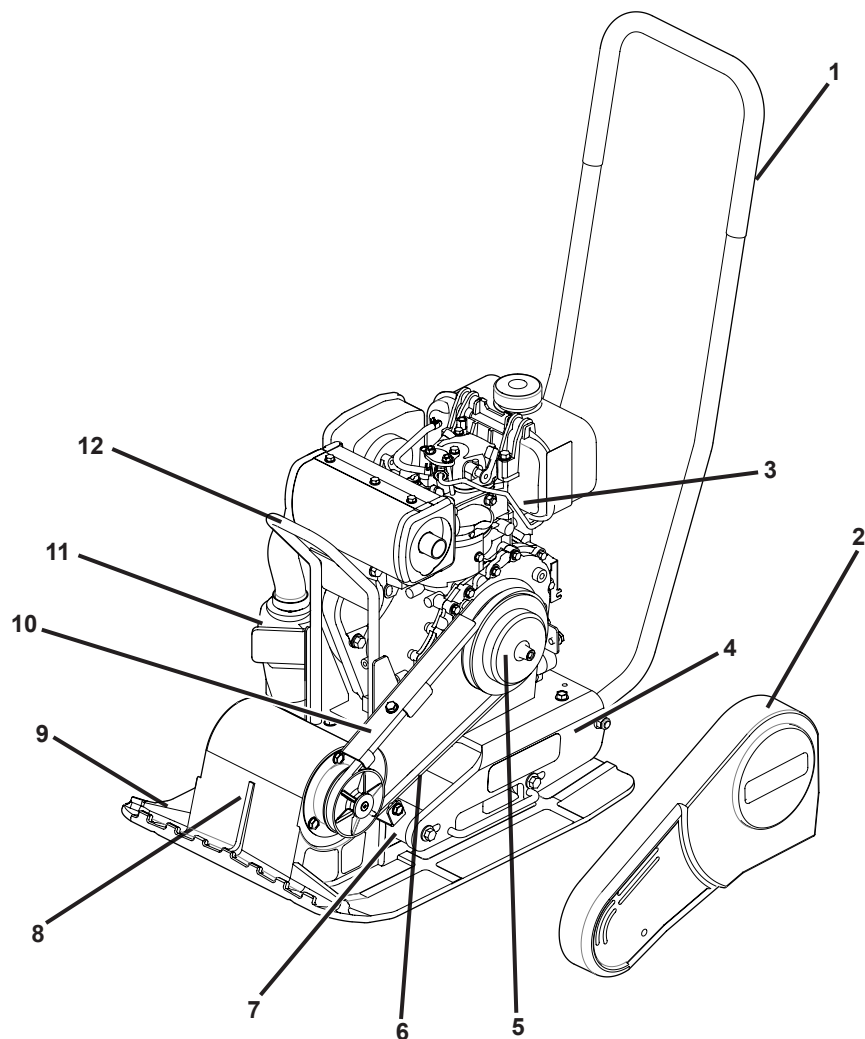

1. Handle
2. Protective cover
3. Diesel engine
4. Engine plate
5. Centrifugal clutch
6. V-belt
7. Rubber damper
8. Vibration element
9. Base plate
10. Bracket, V-belt cover
11. Cyclone filter
12. Lifting eye

DAILY CHECKS

Fuel Check

Check that there is fuel in the tank. Top up if necessary.

Engine Oil Level Check

Check the oil level in the crankcase every day. The oil must reach the edge of the filling hole when the machine is on a level surface.

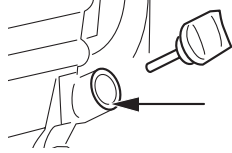

Air Filter Check

The air filter must be checked at least once every working week. When working in dusty conditions, check daily.

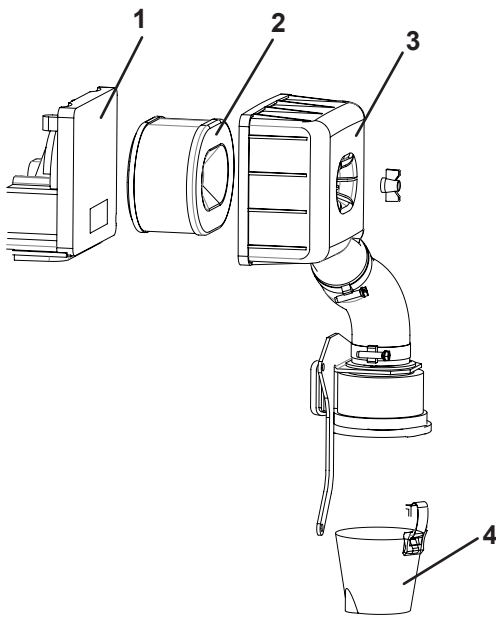

1. Filter plate
2. Paper element
3. Filter cover
4. Cyclone filter collector

Cleaning

1. Remove the paper element and check that they are undamaged. Replace damaged parts.
2. Strike the paper element against a hard object a few times to loosen any dirt.
4. Check that the filter plate is clean. Clear the cyclone filter collector.

V-belt Drive

Check the tension and condition of the V-belt regularly. Replace a damaged V-belt with the new type XPA 990 6T43

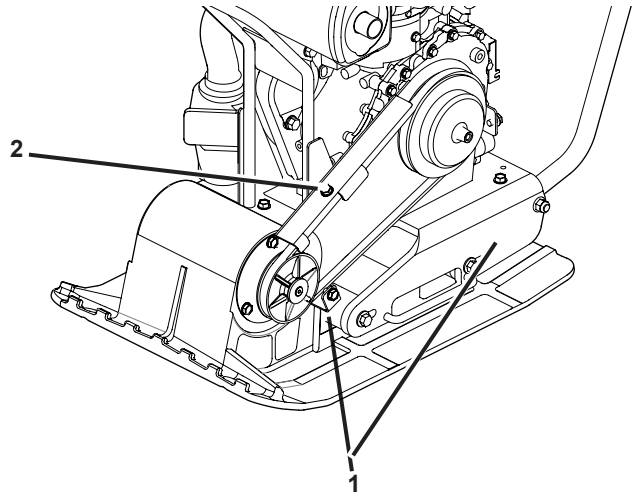

Adjustment of V-belt tension

Loosen the screws (1, 4 pcs) that hold the engine plate. Loosen the screws (2, 3 pcs) holding the cover. Remove the cover.

Tension the V-belt by pulling the handle (3). Tighten the screws. Refit the cover.

Rubber Dampers

Check the condition of the rubber dampers (4, 4 pcs) regularly. Replace damaged dampers.

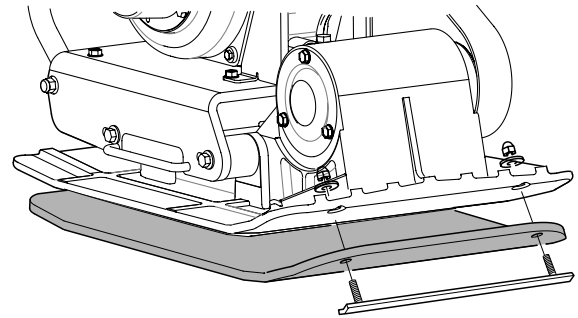

Polyuretan Pad

A polyuretan pad is used for stone paving work to protect against stones and ground clinker.

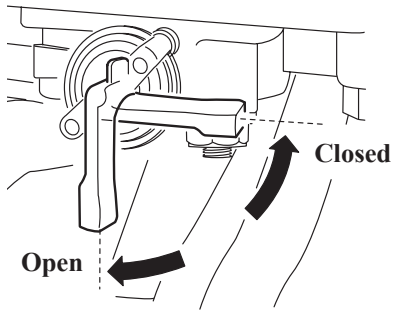

Yanmar fuel cock

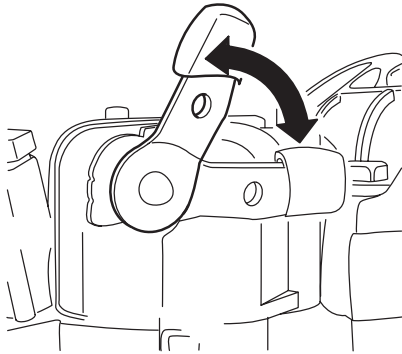

Yanmar decompression handle

BEFORE STARTING

See Daily Checks on page 8.

STARTING

Open the fuel cock.
Start the engine by pulling the start handle on the engine.

Switch the throttle lever to the full RPM position. The best packing ability is reached in this condition.

In very cold weather, starting can be facilitated using the decompression handle in connection with the valve housing. Press the lever down and hold it down until the flywheel has reached its maximum RPM. Run the engine warm for around 5 minutes.

STOPPING

Switch the throttle lever to idle and let the engine run for a few minutes.

Stop the engine by moving the throttle lever to the stop position

At the End of the Day

Close the fuel cock.

DIMENSIONS

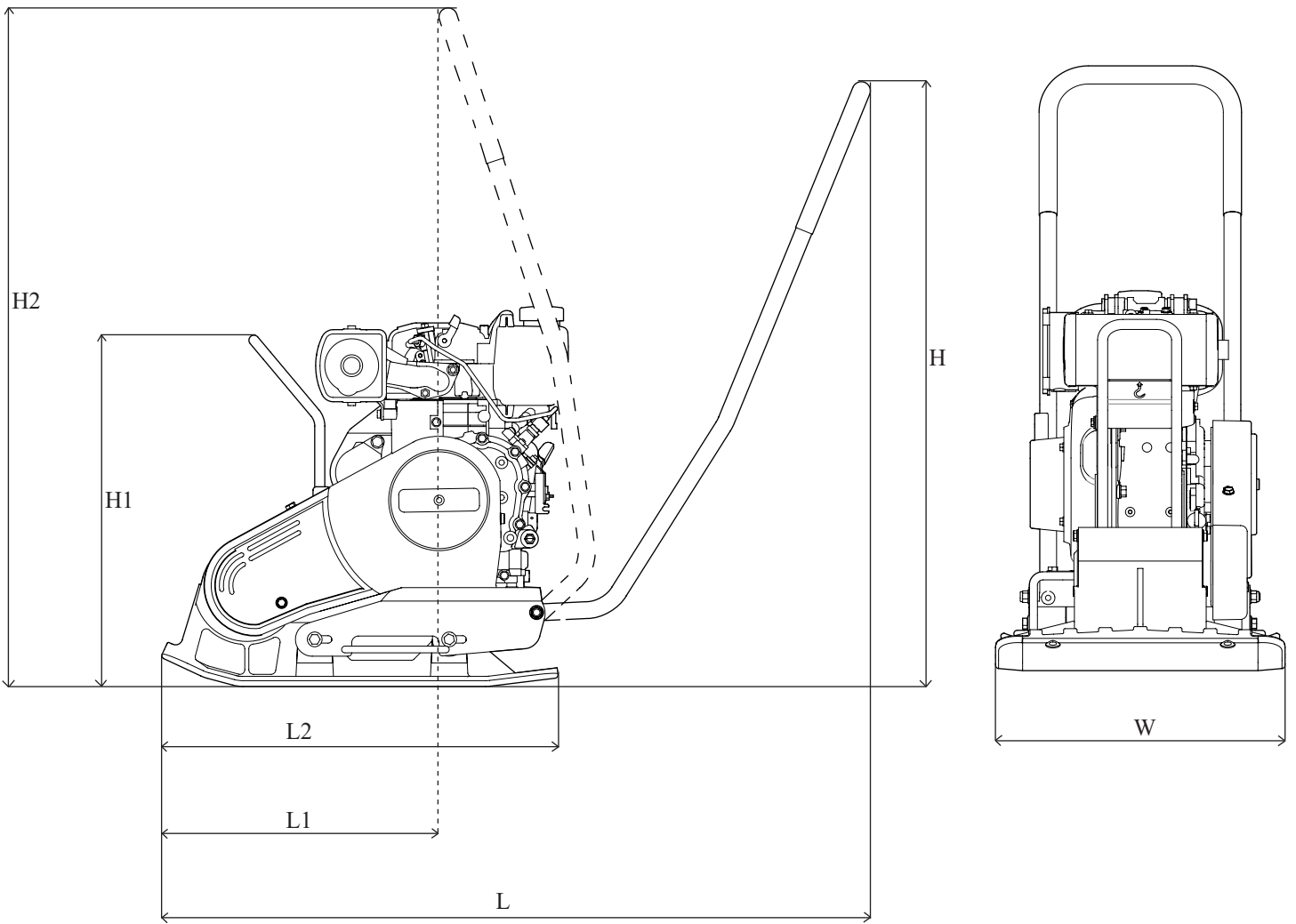

Dimensions in mm

H	H1	H2	L	L1	L2	W
890	430	1010	1050	330	580	460

TRANSPORTATION

It is easy to remove the handle without tools, and the boot of a standard car is sufficient to transport the machine.

Lifting by hand

Remove the handle by pushing it forward and pull apart the shafts so that the fastening tabs release. Stir the handle slightly sideways so that the handle release.

Caution! The machine must be lifted by 2 persons!

Lift by means of the handle on the back and the front edge of the machine.

Lifting with crane

Tilt the handle forward.

Fit a lifting sling to the lifting eye and thread the lifting sling between the shafts of the handle, see illustration below.

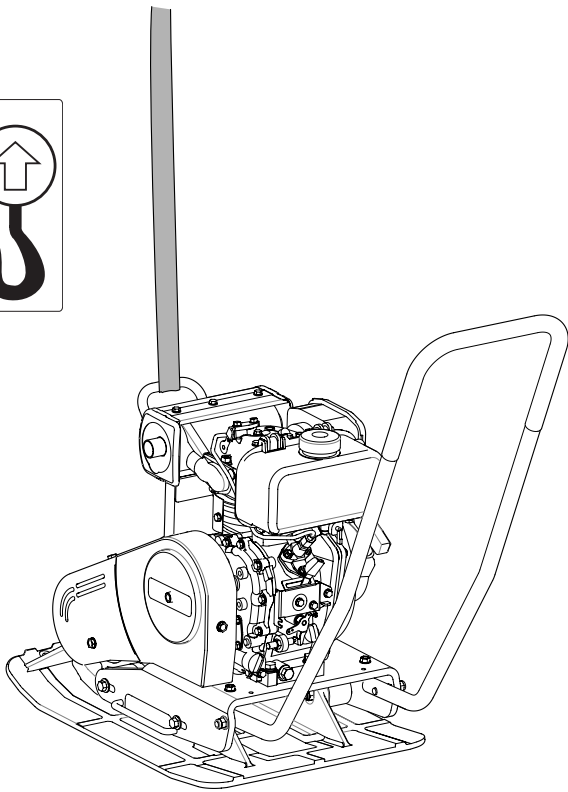
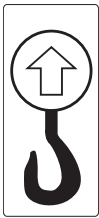

Transport locking

Secure the machine with straps according to illustration during transportation

Note! Secure it by the base plate and not the rubber-cushioned upper part.

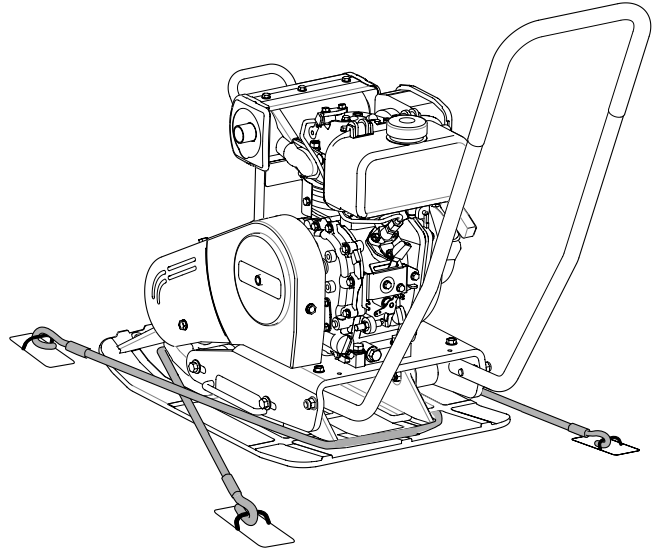

NOTES

NOTES

NOTES



EC-declaration of conformity

Manufacturer

**Swepac AB
Blockvägen 3
34132 Ljungby**

1. Category: Vibratory plate
2. Type: F 100
3. Engine power: F 100 3,5 kW

The product complies with the following directives:

2006 / 42 / EG

2000 / 14 / EG

2004 / 108 / EG

EN 500-1

EN 500-4

Technical documentation held by:

Swepac AB, Blockvägen 3 SE-34132 Ljungby
Tomas Johansson / Product Engineer

SWEPAC

SWEPAC AB

Address **Blockvägen 3, 341 32 Ljungby, Sweden**, tel. **+46 (0)372-156 00**, fax **+46 (0)372-837 41**, E-mail **mail@swepac.se**,
Internet **www.swepac.se**